

① User Interface Introduction

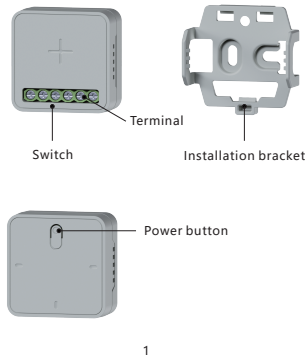

1

② Dimensional Drawing

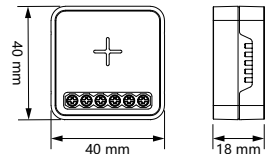

2

③ Disconnect the power supply



Please ensure that the device is installed and maintained by a professional electrician. To avoid the risk of electric shock, do not operate any connections or touch the terminal connector while the device is powered on.

General parameters

Maximum cable section:	2x1.5mm ² 1x2.5mm ²
Operating temperature:	5-40°C
Technology:	Wi-Fi
Exercise frequency:	2.4GHz

④ Installation instructions

Mounted on the rail.

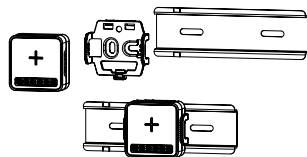

Installed in the wall-mounted box.

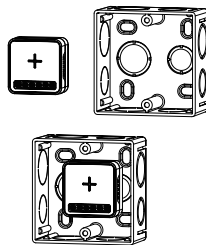

3

Directly mounted on the wall.

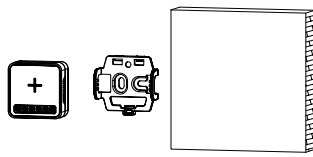

4

⑤ Wiring Instructions

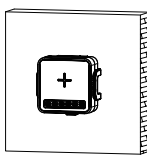

4

Smart Wi-Fi 1-Gang Switch
max 10A

Model: ETWF4007

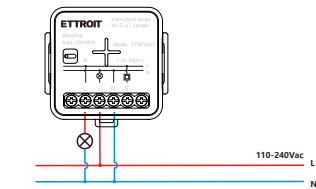
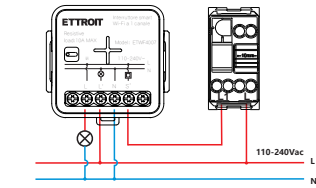

Alimentazione:	110-240Vac, 50/60Hz
Portata contatti:	10A MAX
Potenza Massima:	2300W

5

Smart Wi-Fi 1-Gang Switch with
Energy Monitoring max 16A

Model: ETWF4008

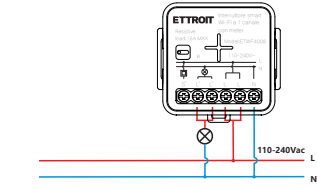
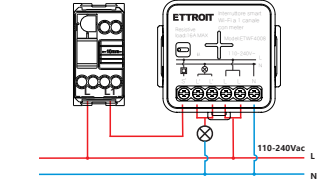

Alimentazione:	110-240Vac, 50/60Hz
Portata contatti:	16A MAX
Potenza Massima:	3680W

6

Smart Wi-Fi 2-Gang Switch
max 10A

Model: ETWF4009

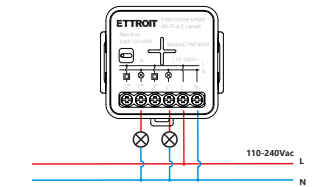
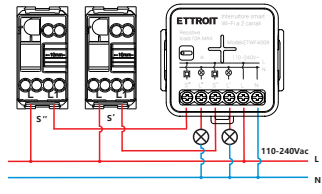

Alimentazione:	110-240Vac, 50/60Hz
Portata contatti:	5A MAX
Potenza Massima:	1150W

7

Smart Wi-Fi 1-Gang Dimmer
max 150W

Model: ETWF4010

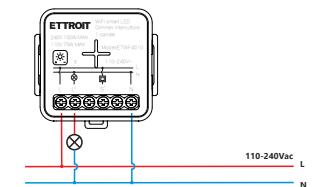
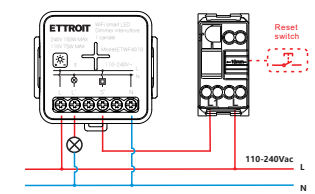

Alimentazione:	110-240Vac, 50/60Hz
Carico:	110V 75W 240V 150W

8

Smart Wi-Fi Curtain Switch
max 2.5A

Model: ETWF4011

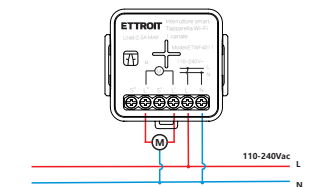
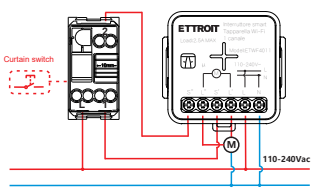

Alimentazione:	110-240Vac, 50/60Hz
Portata contatti:	2.5A MAX

9

Smart Wi-Fi Garage Door Switch
A set of signals

Model: ETWF4021

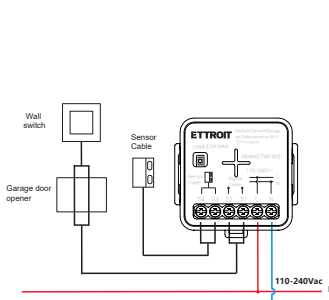

Alimentazione:	110-240Vac, 50/60Hz
----------------	---------------------

10

⑥ Download the Tuya App



⑦ Power on

Insert the plug into the wall outlet. Upon initial power-up, the device will automatically enter network configuration mode, and the power button indicator will blink.

⑧ The device will exit Pairing Mode if not paired within 3 minutes. To re-enter this mode, press and hold the "Power button" key for 6 seconds. The indicator light will flash, and the Device will enter Re-Distribution Network Mode.

⑨ Add device

Tap "+" and select "Add Device," then follow the prompts in the app.

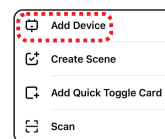

11

WEEE and consumer rights

Read carefully before use and keep for future reference

- Touching the units with hands is prohibited.
- Using liquid cleaners or aerosols is prohibited.
- Modifying the devices is prohibited.
- Removing protective parts from the devices is prohibited.
- Exposing the unit to water drops or splashes is prohibited.
- Installing the units near heat/cold sources or hot/cold air emission points is prohibited.
- Installing the units near harmful gases and powders is prohibited.
- Fastening the units on unsuitable surfaces is prohibited.

WEEE Disposal and Recycling Information

All products bearing this symbol are classified as Waste Electrical and Electronic Equipment (WEEE, as per Directive 2012/19/EU) and should not be mixed with unsorted household waste. Instead, you should protect human health and the environment by taking your waste equipment to a designated collection point for the recycling of electrical and electronic waste, as appointed by the government or local authorities. Proper disposal and recycling will help prevent potential negative effects on the environment and human health. Please contact the installer or local authorities for more information regarding the location, terms, and conditions of such collection points. IMPORTED BY SPACE-C SRL VAT NUMBER 10607671210



12